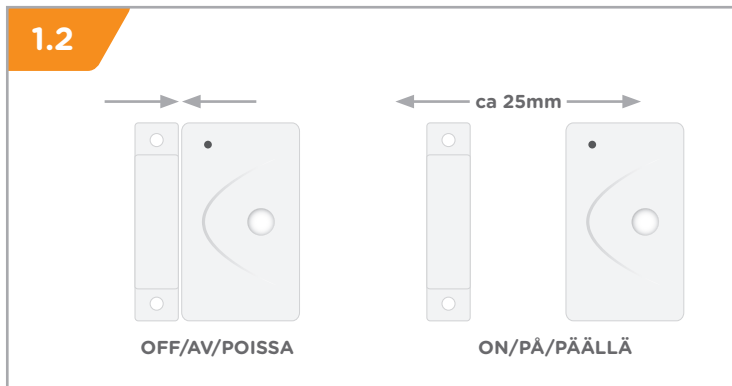
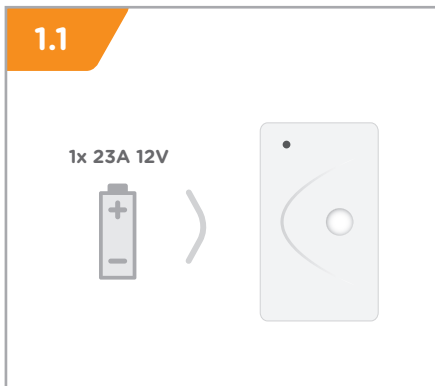

1. INSTALLATION

1. INSTALLASJON

1. INSTALLATION

1. ASENNUS

**2. CONNECT SENSOR TO RECEIVER**

2. KOBLE SENSOR TIL MOTTAKER

2. KOPPLA SENSOR TILL MOTTAGARE

2. LIITÄ ANTURI VASTAANOTTIMEEN

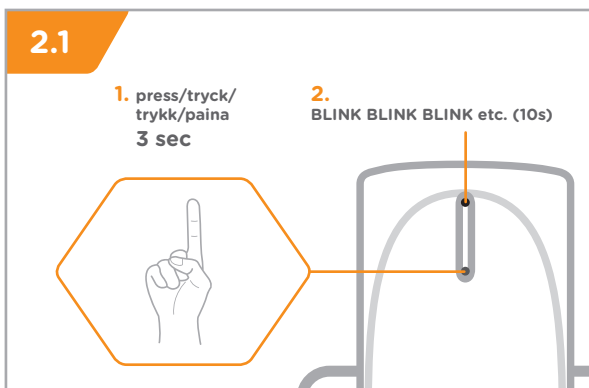
**3. CONNECT SENSOR TO TELLSTICK NET**

3. KOBLE SENSOR TIL TELLSTICK NET

3. KOPPLA SENSOR TILL TELLSTICK NET

3. LIITÄ ANTURI TELLSTICK NET:iin

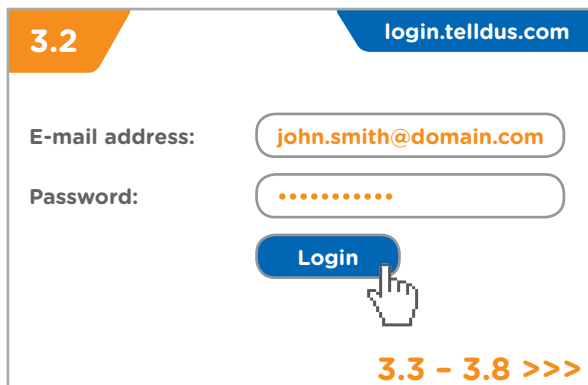

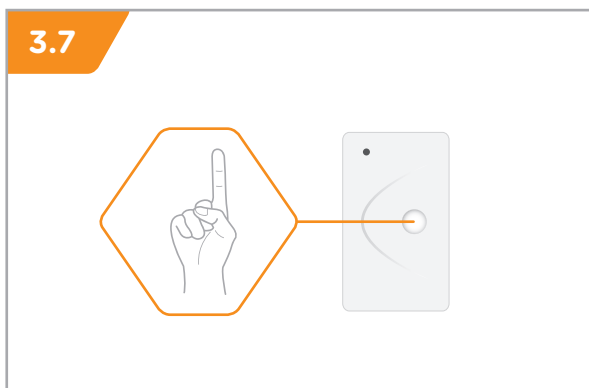
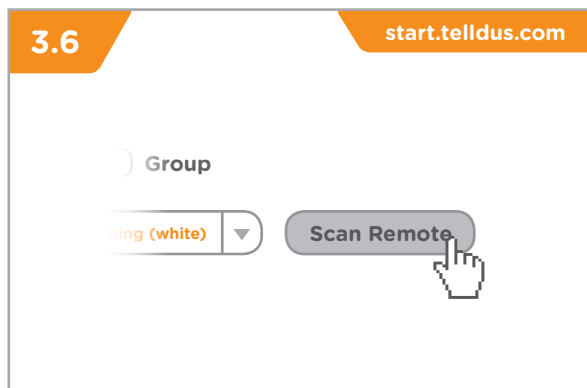
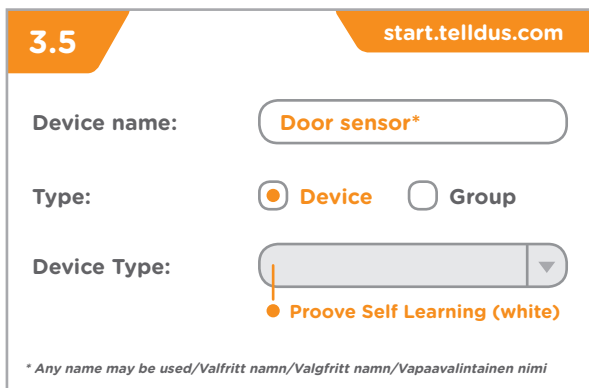

Explore/Upptäck/Oppdag/Lisätietoja: www.proovesmart.com

Use the Event function for more advanced control of your sensor.

Använd Event-funktionen för ännu mer avancerad kontroll av din sensor.

Bruk Event-funksjonen for enda mer avansert kontroll over sensoren.

Käytä Event-toimintoa anturin monipuolisempaan hallintaan.

Specifications/Specifikationer/Specifikasjoner/Tekniset tiedot

Range/Räckvidd/Rekkevidde/Kantomatka	ca 30m
Protection class/Skyddsklass/Verneklasse/Suojausluokka	IP20
Frequency/Frekvens/Frekvens/Taajuus	433.92MHz
Battery/Batteri/Batteri/Paristo	.1x 23A 12V